

UltraGroove™ and UltraGroove™ Metal

Retractable Tonneau Covers

INSTALLATION INSTRUCTIONS NISSAN TITAN

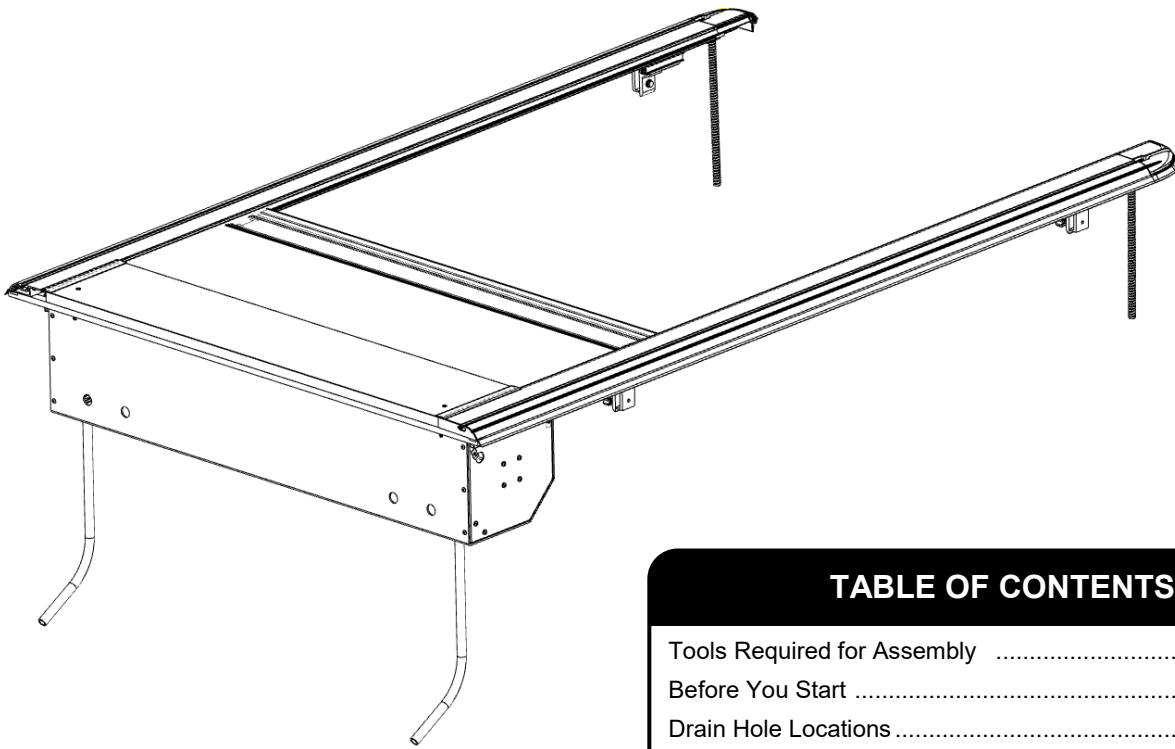

(800) 338-3697

www.paceedwards.com

Pace Edwards Company

2400 Commercial Blvd.

Centralia WA 98531

TABLE OF CONTENTS

Tools Required for Assembly	1
Before You Start	1
Drain Hole Locations	1
STEP 1: Remove From Packaging, and Hardware and Packaging Contents	1
STEP 2: Positioning Canister	2
STEP 3: Installing Rails	2
STEP 4: Installing Top Cover	4
STEP 5: Installing Clamp Extensions	5
STEP 6: Installing Clamps	6
STEP 7: Installing Tailgate Drain Tubes	9
STEP 8: Lubricating Sweep Seals	9
STEP 9: Installing Canister Drain Tubes	10
STEP 10: Attach the Pull Strap	10
Operating Instructions	10
Maintenance	11
Warranty Statement	12

TOOLS REQUIRED FOR ASSEMBLY

Tape Measure

Side Cut or Needle Nose Pliers

Masking tape

1/8 Allen Wrench

#2 Phillips Screwdriver

Utility Knife

5/32 Allen Wrench

Note: There should be no drilling into the truck body needed on most standard or full-size trucks.

BEFORE YOU START!

Read the instructions carefully before you start. If you have any questions regarding the installation please call our Technical Support Line at (800) 338-3697.

CANISTER DRAIN HOLE LOCATIONS:

This tonneau cover is designed to carry rainwater from the cover into the canister and then out through the drains. Most truck models have standard OE drain holes or plastic/rubber access ports in the front of the truck bed. Check to make sure your truck has the OE drain holes so that drilling into the sheet metal is not required. If drilling is necessary, be sure to check the underside of the truck bed for the best location. The holes should be located near the side and as far forward as possible. Use a drill bit suitable for sheet metal (such as a taper drill or step drill). Drill drain tube clearance holes at 3/4" (19mm). This will need to be done before installing the cover.

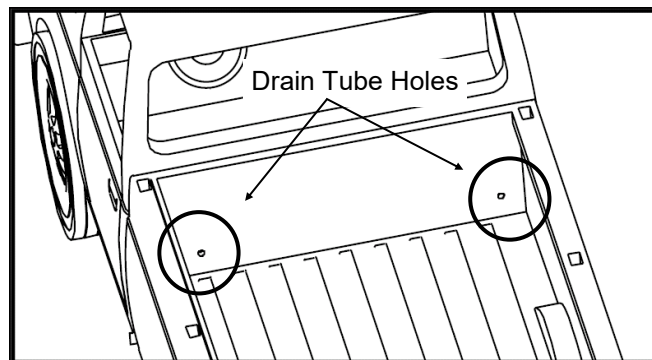

STEP 1: REMOVE FROM PACKAGING AND REVIEW CONTENTS

A complete unit will consist of one canister box (marked box 1 of 2) and one rail box (marked box 2 of 2). Remove the Top Cover, Canister, Clamp pack, Hardware pack, Foam, Clamp Extensions and Drain Tubes from the Canister box. Remove the rails from the rail box (see caution below). Perform a quick inventory of the packaging contents to ensure all parts are there.

CAUTION!

TO AVOID SCRATCHING THE SURFACE OF THE RAILS, DO NOT SLIDE THEM OUT THE END OF THE BOX. OPEN THE BOX ALONG THE LENGTH, USE PLIERS TO PULL THE STAPLES, LIFT THE RAIL OUT. DO NOT USE A KNIFE TO CUT THE BOX OPEN.

CAUTION!

PACKAGING CONTENTS:

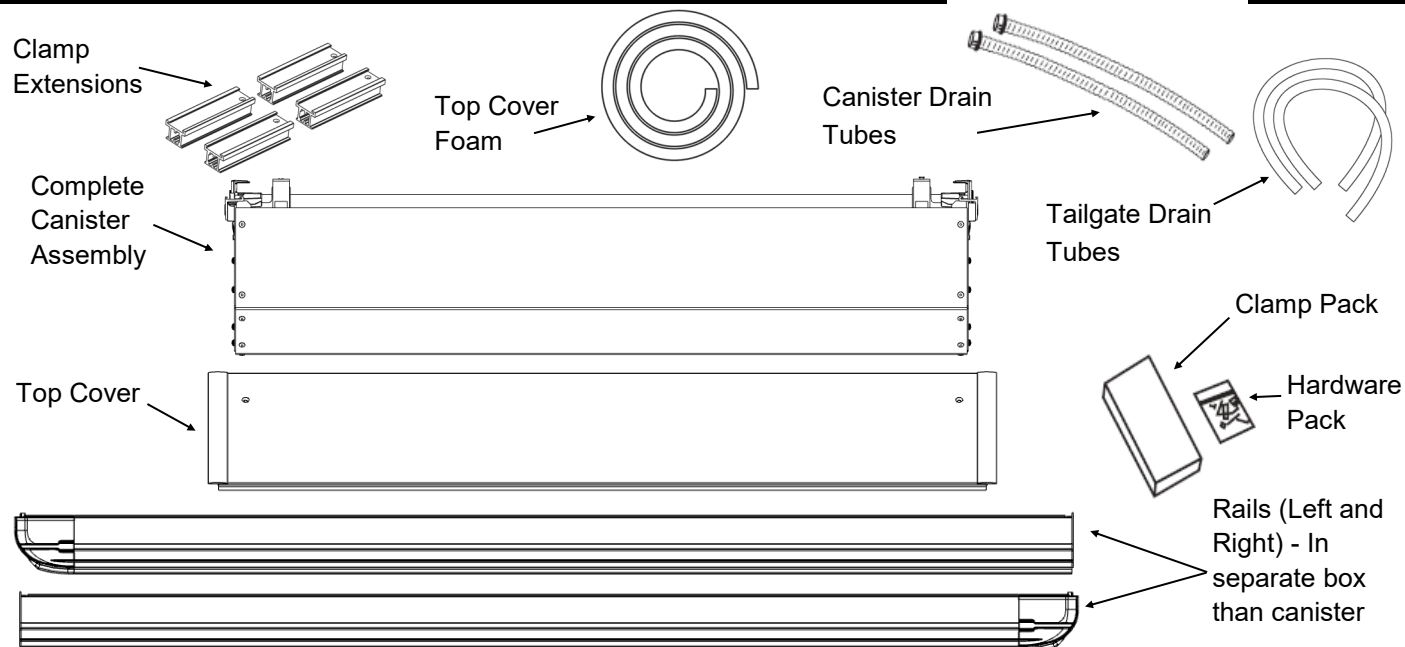

STEP 2: POSITIONING CANISTER

Use the Pull Strap and the canister body to lift and steady the unit. Wrap the Pull Strap around the center of the canister a couple times and double it up in your hand. (If you have someone to help you, you can jump to step 3 and install the assembled canister and rails on the truck)

Place the Canister in truck bed just behind the cab and center it from side to side. You will need to place the canister on elevating objects, such as the box the canister came in or 5 gallon buckets. **Note:** Ensuring that the canister is centered in the bed will help assemble the rails to canister in the next step.

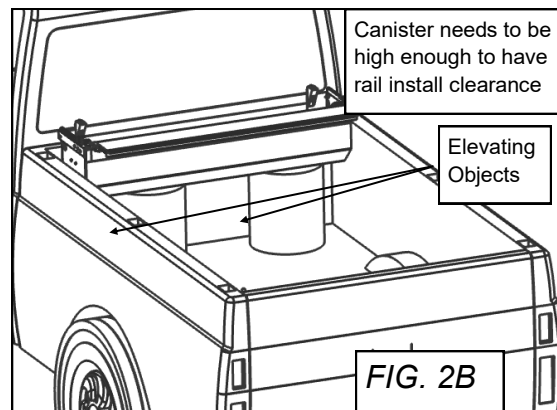
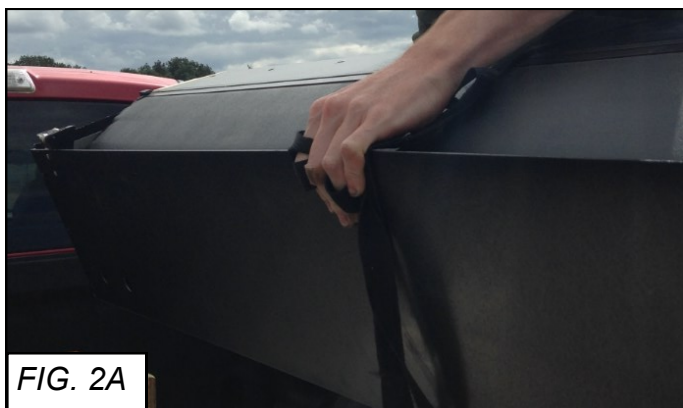

STEP 3: INSTALLING RAILS

Remove the protective paper from the foam on the underside of the Rail flanges. This is for packaging purposes only. Next identify the left and right side rails (FIG 3A). The rail flange and foam towards the outside of the truck bed.

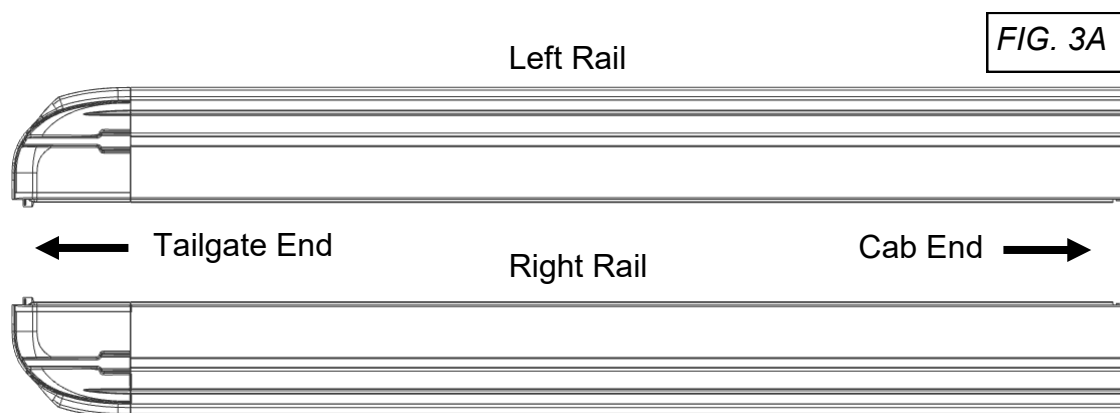
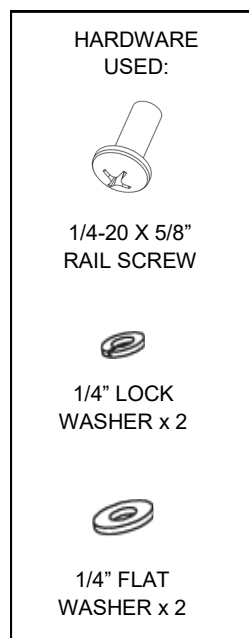

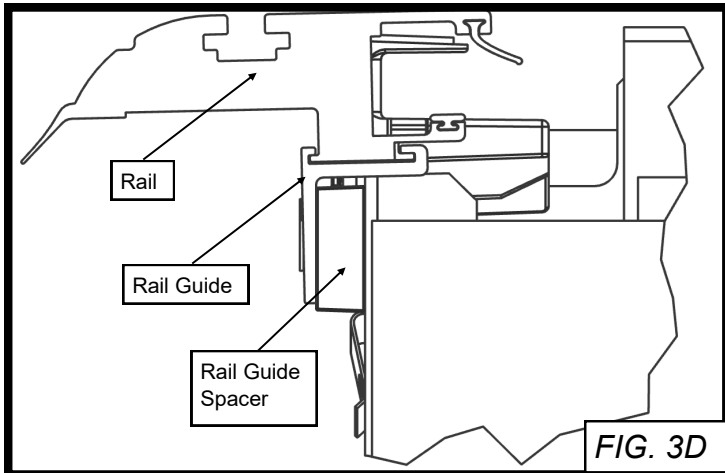
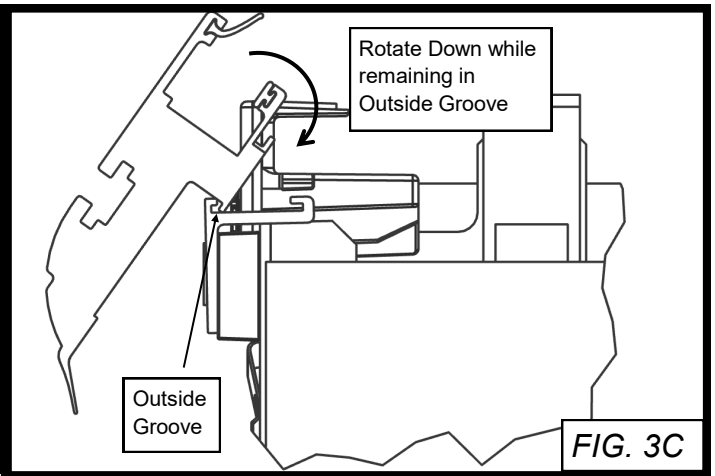
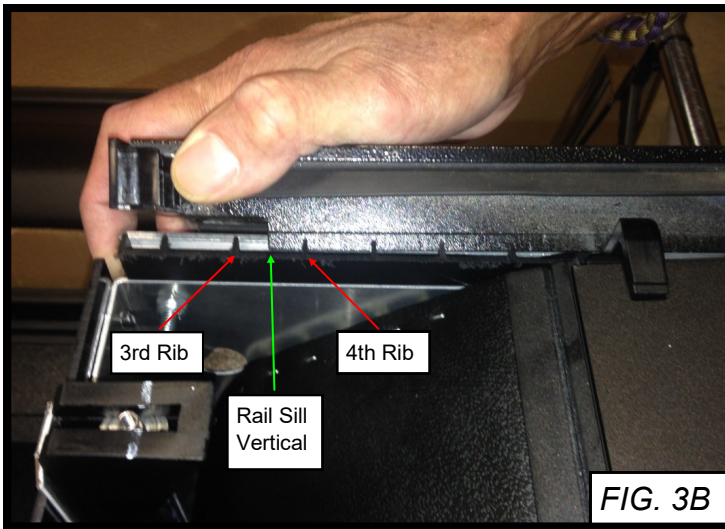

First make sure your handle latches are in, this makes the rail install much easier (FIG 3F).

WARNING: IF YOU DO NOT HAVE THE LATCHES IN, THE HANDLE WILL CATCH THE RAIL AS YOU ATTEMPT TO SLIDE IT IN.

Next line up the Rail sill vertical between the 3rd and 4th Rib of the Rail Guide Spacer (FIG 3B). Then hook the Outside Groove of the rail into the Rail Guide and rotate down until the rail and rail guide are level (FIG 3C & 3D). Now push the rail all the way forward (FIG 3E). Finally you can install the Rail Screw, Flat and Lock Washer securing the rail to the canister (FIG 3G).

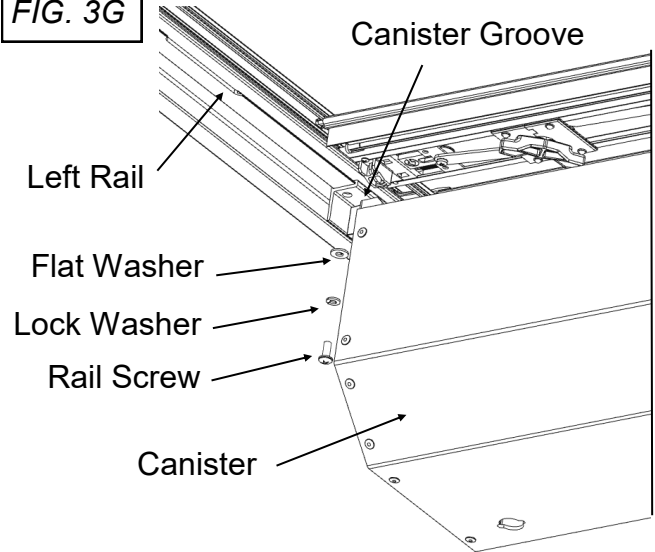

FIG. 3F



Installing the rails is easier with the handle latches in. For information on handle operation reference Figure 11A.

FIG. 3G



The Rail shown is for REFERENCE and may not exactly match your particular Rail geometry.

STEP 4: INSTALLING THE TOP COVER

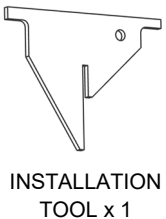

Shut the tailgate and pull the rails back until the tailgate cap seals have good engagement with your tailgate. A good way to check for proper engagement is to make sure the bottom cap and tailgate have 1/4" gap (FIG 4A).

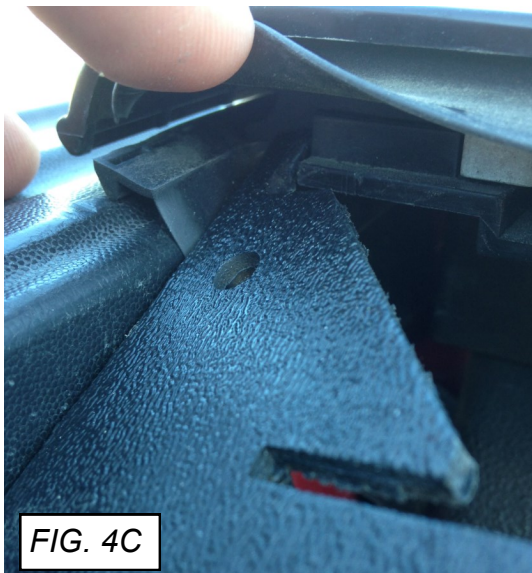
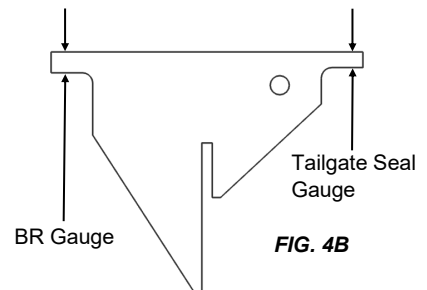
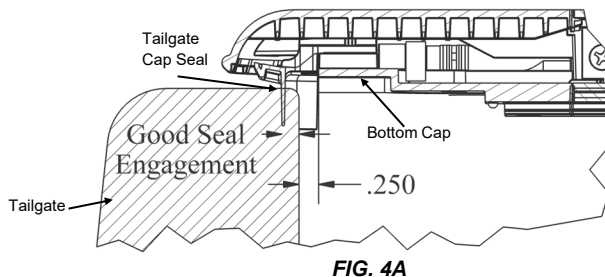

Another way to set the tailgate cap seals is to use the Tailgate Seal Gauge as shown in figure 4B & 4C. You should be able to just slide the Tailgate Seal Gauge in between the Tailgate Cap Seal and the Bottom Cap.

WARNING: Proper Tailgate Cap Seal Engagement is important for getting the best possible water resistance out of your cover!

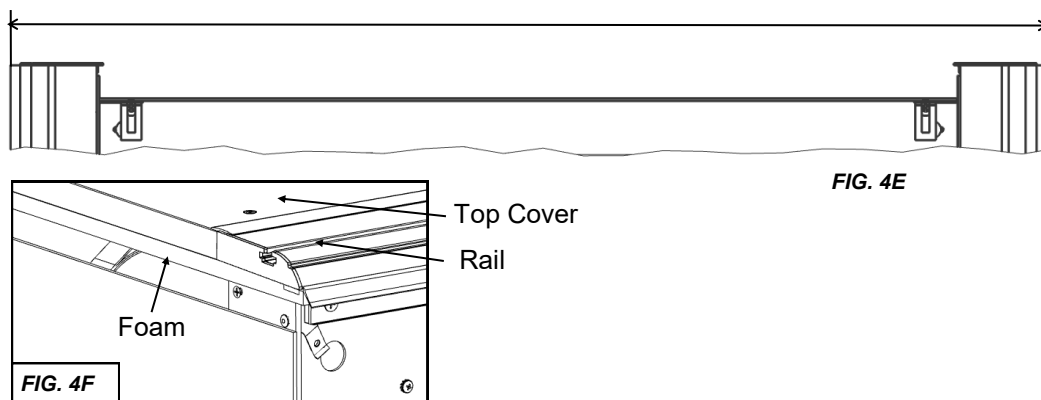

Next mark where the front of the rails sit and mark this position with masking tape, this will be a guide for placing your foam. (FIG 4D). Now pull the cover back until there is room to apply the foam. Lay the foam on the front sill of the truck from rail to rail, trimming the excess with a utility knife (FIG 4E).

Now scoot the rails and canister back on the foam and double check that your tailgate seal engagement is good. You can now install your top cover with the two included screws while making sure it aligns with the front of your rails (FIG 4F).

WARNING: Proper top cover foam installation is important for getting the best possible water resistance out of your cover!

STEP 5: INSTALLING THE CLAMP EXTENSIONS

Slide the clamp extensions from the tailgate end of each rail as pictured in Figure 5A-5E. Ensure that your tailgate end and cab end extensions are in the correct orientation. Each clamp extension is labeled for front left (FL), front right (FR), back left (BL), and back right (BR). The extensions go on the corners shown in figure 5A.

Once you have the clamp extensions on the cab and tailgate end of the rails as shown in Figure 5E and tighten the set screws with a 5/32" Allen Wrench. If you have trouble sliding on the clamp extension, make sure your set screw is not sticking out the top of the clamp extension.

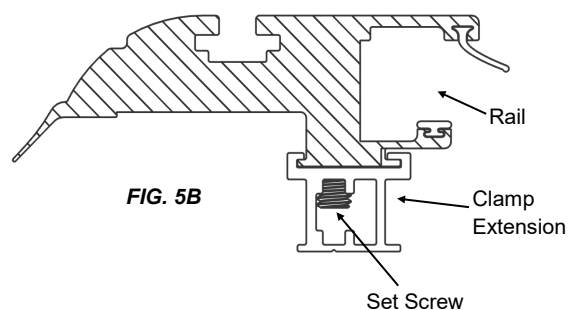
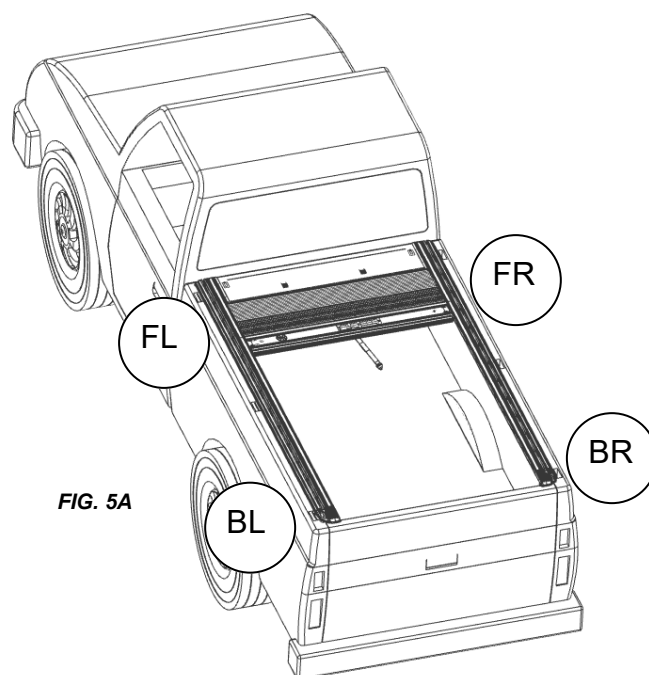

TAILGATE END

FIG. 5C

FIG. 5D

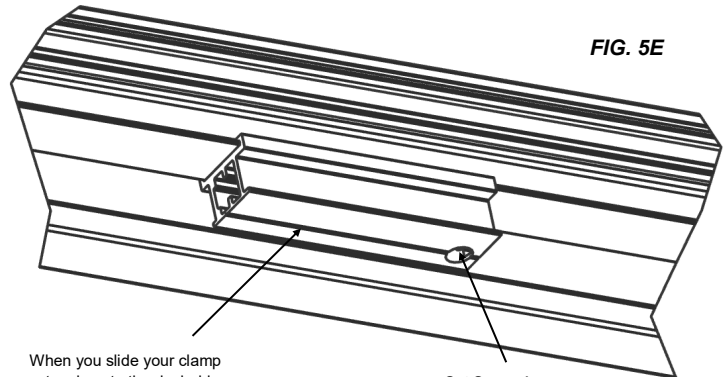
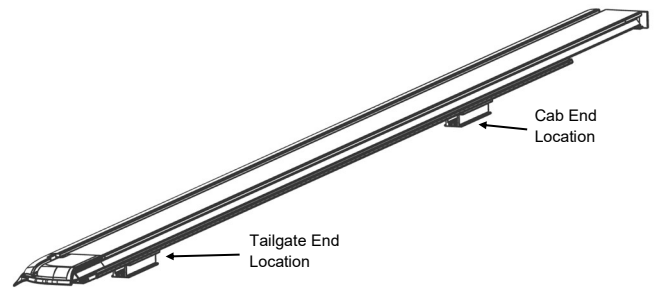
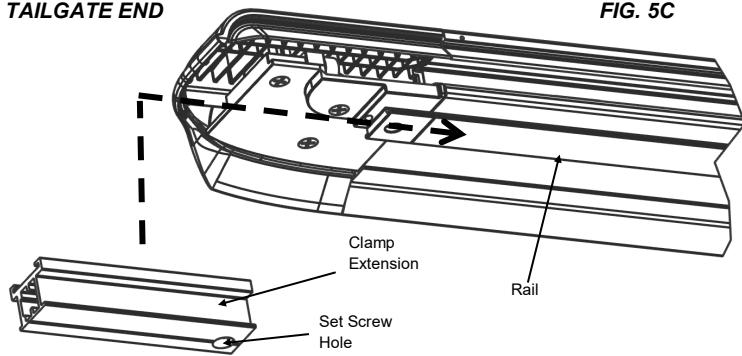

When you slide your clamp extensions to the desirable tailgate and cab locations tighten the set screw with a 5/32" allen wrench

STEP 6: INSTALLING THE CLAMPS

Slide the Clamp Grip onto the Clamp Extension from the tailgate to the canister (Fig 6A). Next install the set screw into the Clamp Extension with an 1/8" Allen Wrench (Fig 6B). Then assemble the rest of the clamp parts as shown on the next two pages. Be sure to the proper clamp combination for your truck. Figure 6D is the clamp assembly for trucks with the Utili-Track System Track and Figure 6E is for trucks without the Utili-Track System Track.

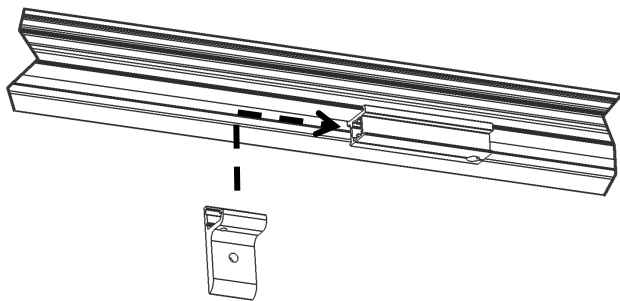

FIG. 6A

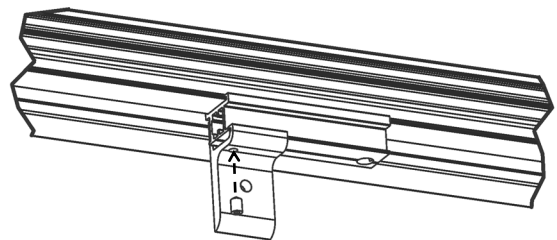
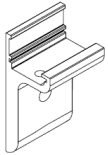

FIG. 6B

STEP 6 CONTINUED... INSTALLING THE CLAMPS ON TRUCK WITH UTILI-TRACK CHANNEL SYSTEM

HARDWARE USED:



(1) CLAMP GRIP X4

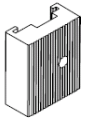

(2) RAIL GRIP BLOCK X4



(3) CLAMP SHIM X4

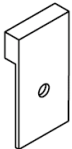

(4) CLAMP SPACER X4

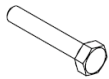

(5) CLAMP RAIL BOLT X4



(6) 1/4" LOCK WASHER x 4



(7) 1/4" FLAT WASHER x 4



(8) ALLEN SCREWS X4

FIG. 6D

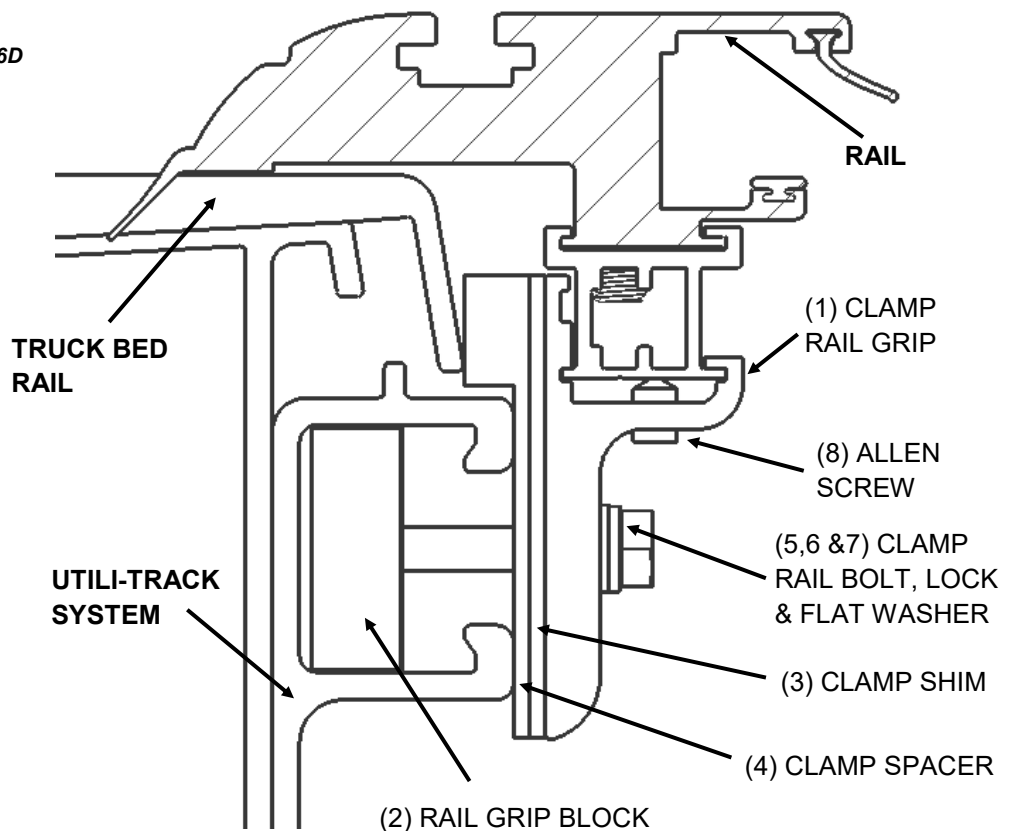
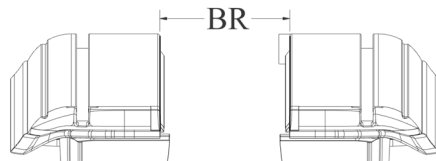

FIG. 6C



Part number is on the serial number label in the upper left corner of the canister (looking from tailgate).

PART NUMBER	BETWEEN RAILS (BR)
KR and KM2067	57 1/16
KR and KM2068	57 1/16
KR and KM2114	57 7/16
KR and KM2115	57 7/16

Before shimming and installing the rail clamps make sure the canister is centered between the truck bed rails.

Install the Rail Grip Blocks (2) into the track system on the truck bed with the grip lines running vertically (up and down). Position them behind the Clamp Rail Grips (1)

The between the rail dimension should match the chart to the right of FIG. 4A. Use the shims to achieve this measurement on the front clamp assembly and the tailgate end clamp assembly, take the Clamp Shims (3) and the Clamp Spacer (4) and fit them behind the Clamp Rail Grip (1) and up against the inner bed rail lip.

Thread the Clamp Rail bolt (5) with the Lock Washer (6) and Flat Washer (7) and put it through the Clamp Rail Grip (1) and thread it into the Rail Grip Block (2). Tighten the bolts making sure the rails stay level with the truck bed rails as you tighten.

Place the 4 allen screws (8) in the clamp rail grips as indicated in Figure 5a and tighten them.

Re-measure the distance between the rails at the canister and tailgate. This distance should be the same to allow your cover to operate properly. You can also use the installation tool to check your BR dimension (Fig 6F). Push the handle to the right and if you can slide the Installation tool between the Rail Metal and the Handle Stop as shown you need to add shims to your clamps.

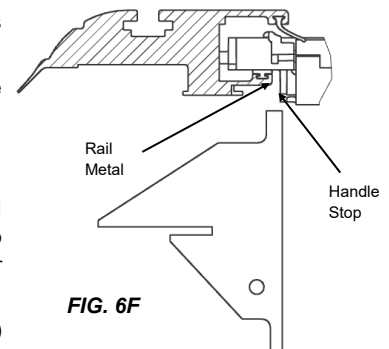
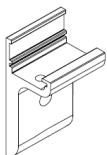

FIG. 6F

STEP 6 CONTINUED... INSTALLING THE CLAMPS ON TRUCK WITHOUT UTILI-TRACK CHANNEL SYSTEM

HARDWARE USED:



(1) CLAMP GRIP X4

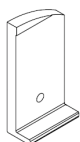

(2) RAIL BACK PLATE
X4



(3) CLAMP SHIM X4

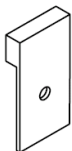

(4) CLAMP SPACER
X4

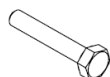

(5) CLAMP RAIL
BOLT X4



(6) 1/4" LOCK
WASHER x 4



(7) 1/4" FLAT
WASHER x 4



(8) ALLEN SCREWS
X4

FIG. 6E

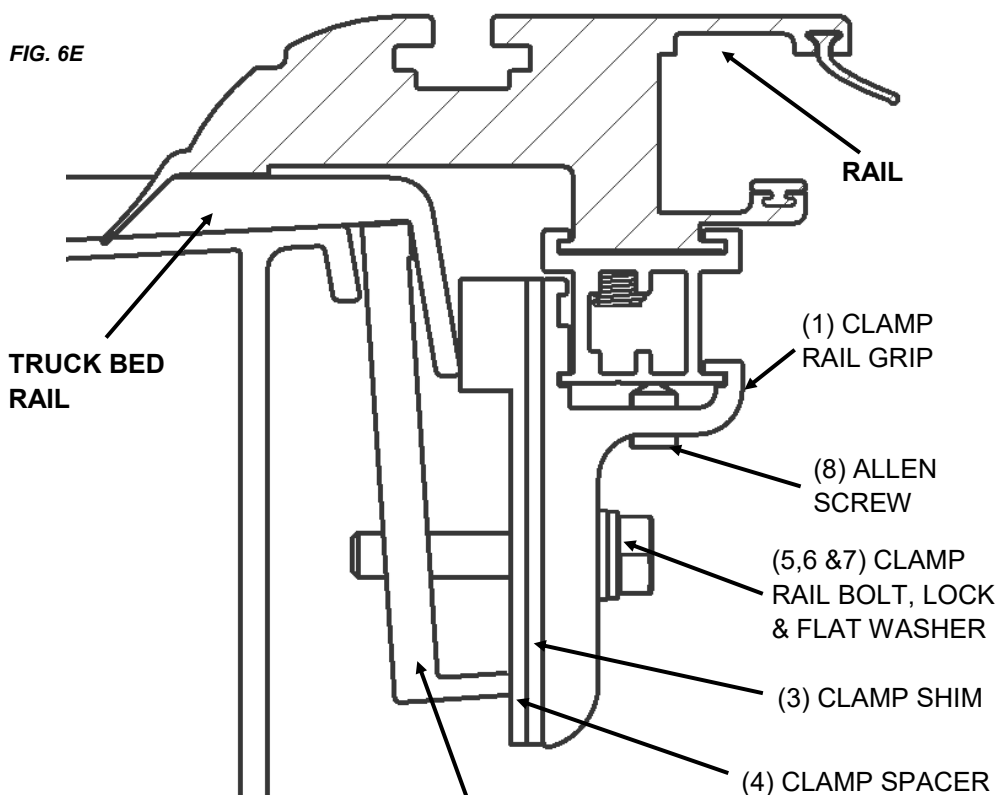
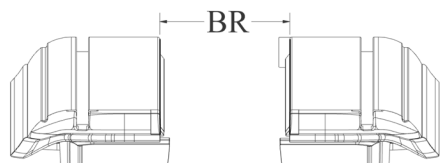

FIG. 6C



Part number is on the serial number label in the upper left corner of the canister (looking from tailgate).

PART NUMBER	BETWEEN RAILS (BR)
KR and KM2114	57 7/16
KR and KM2115	57 7/16

Before shimming and installing the rail clamps make sure the canister is centered between the truck bed rails.

The between the rail measurement should match the chart to the right of FIG 4A. Use the shims to achieve this measurement on the front clamp assembly and the tailgate end clamp assembly, take the Clamp Shims (2) and the Clamp Spacer (3) and fit them behind the Clamp Rail Grip (1) and up against the inner bed rail lip.

Thread the Clamp Rail bolt (4) with the Lock Washer (5) and Flat Washer (6) and put it through the Clamp Rail Grip (1) and thread it into the Clamp Back Plate (7). Tighten the bolts making sure the rails stay level with the truck bed rails as you tighten.

Place the 4 Allen Screws (8) in the clamp rail grips as indicated in Figure 5a and tighten them.

Re-measure the distance between the rails at the canister and tailgate. This distance should be the same to allow your cover to operate properly. You can also use the installation tool to check your BR dimension (Fig 6F). Push the handle to the right and if you can slide the Installation tool between the Rail Metal and the Handle Stop as shown you need to add shims to your clamps.

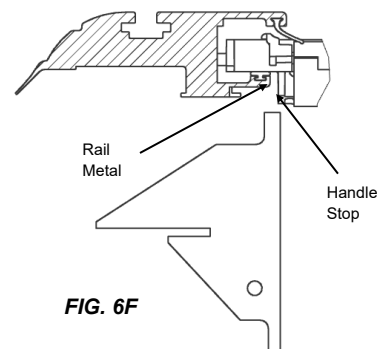

FIG. 6F

STEP 7: INSTALLING TAILGATE DRAINTUBES

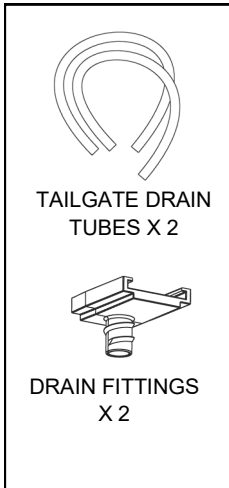
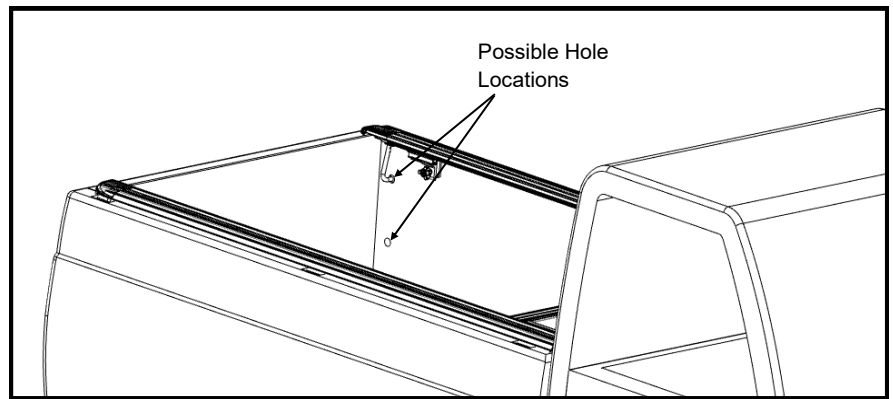
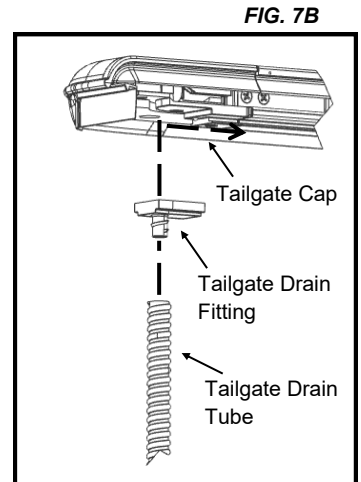

FIG. 7A

To install the tailgate drain tubes you need to find suitable holes in the rear stiffener of your truck bed. Figure 7B shows possible hole locations.

Next you will screw the drain tube into the drain fitting and slide it on the tailgate cap as shown in figure 7C. There is an interference bump on the cap that will lock the drain fitting in place. Next you will need to thread the drain tube in the desired hole and trim the length of the tube if needed. If there are no holes on the tailgate side of your truck you will need to drill holes, make sure to check for wires you could damage first (5/8" or 16mm).

WARNING: Proper top cover foam installation is important for getting the best possible water resistance out of your cover!



STEP 8: LUBRICATING & PLACING THE SWEEP SEALS

Locate the sweep seals (rubber weather strips) on the rails. Use the provided UV protectant to wipe the underside of the sweep seal and the top of the wear strip on each rail. The UV protectant can be found adhered to the underside of the top cover lid or in the hardware pack.

Extend the cover to the tailgate. Use an Allen Wrench if needed to carefully draw out the sweep seal (seal should be angled outwards toward the cover—not rolling in toward the bed rail). (Fig 8A)

Proper care and placement of the sweep seal will ensure smooth operation of the cover. Alcohol, petroleum or silicone based cleaners should be avoided and ARE NOT recommended for our covers.

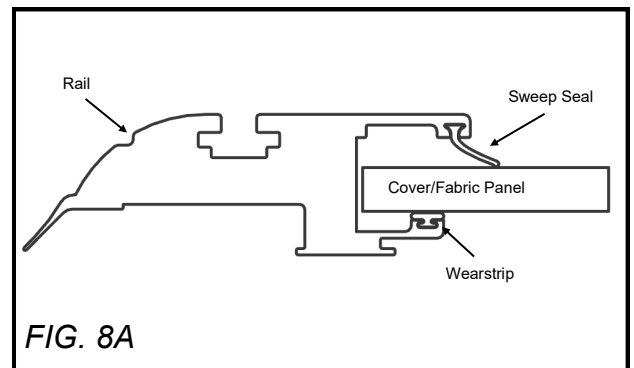

STEP 9: INSTALLING CANISTER DRAIN TUBES

First, ensure that the Foam Washer is in place on the Drain Fitting as this washer will help prevent water leakage. Next, test fit the drain tube to determine the length you want to trim it. Always caution on the long side. Trim the end that will be inserted through the truck bed using the wire cutters or a utility knife.

With the cover *opened*, insert the drain tube fittings into the pre-drilled holes on the underside of the canister by pushing them in place from under the canister. Drain Fitting should click into place.

Place the other end of the drain tube through the plastic/rubber access port or through the pre-drilled holes in the floor or the front wall of the truck bed. If routing through the front wall, ensure that the drain tubes are inserted and directed down so water flows out of the truck.

To remove the drain tubes reach under the canister, grab the drain tube fitting and turn it while applying light downward pressure. When the retaining tabs align with notches in the bottom of the canister the Drain Tube and Fitting will drop out.

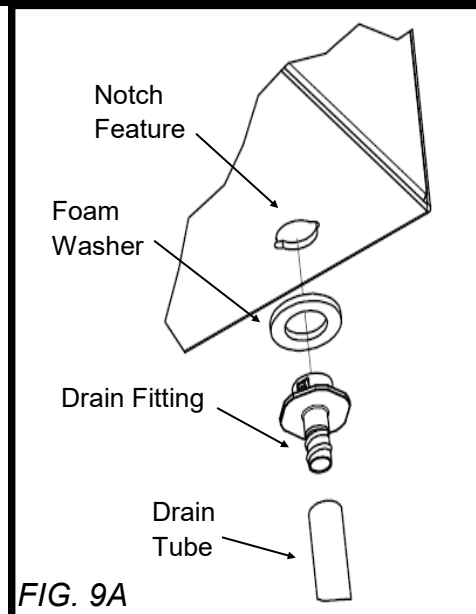

STEP 10: ATTACH THE PULL STRAP



Retract the cover the fully open position. Attach the 4" Velcro strip onto the Velcro strip already attached to the pull strap. Pull the pull strap over to the driver's side rail and remove the tape from the 4" Velcro strip. Then apply the Velcro strip onto the underside of the rail at your desired position. This will hold the pull strap off of the floor and out of the way when cargo is being stored in the truck bed.

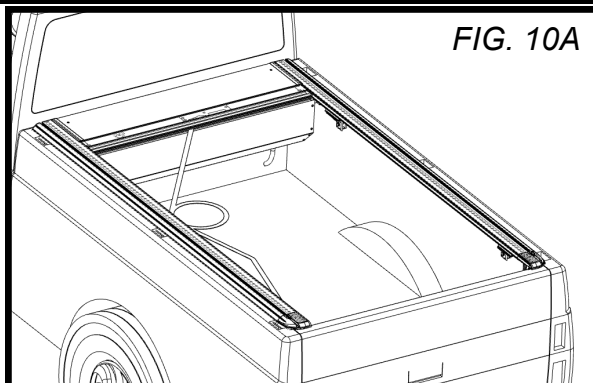

OPERATING INSTRUCTIONS

1. To open the cover, turn the actuator knob clockwise 90° until it clicks in the open position. This retracts the latches into the handle and the cover is free to roll open into the canister. A tug on the pull strap will release the latch and allow the cover to lock into the rails.
2. To latch the cover in one of the mid-range positions, pull it back just beyond the position desired and allow the cover to retract until it latches into place. Latching positions are located every 12 inches along the rails. The clicking sound is the spring-loaded latches mounted inside the handle. The latches are designed to bypass the latching positions as the cover is being closed and to stop the cover as it is being retracted.
3. To close the cover, pull on the strap to draw it back toward the tailgate. When it is within easy reach, grasp the handle by the hand grip and pull the cover to the latching position against the tailgate.

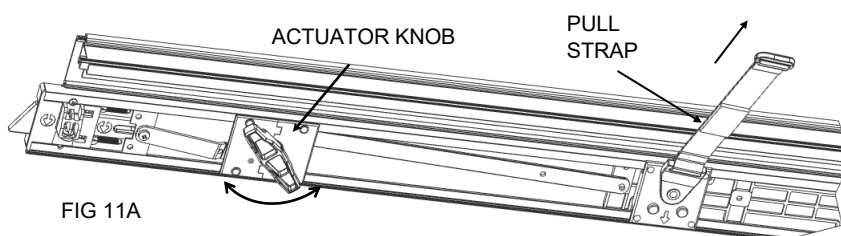

MAINTENANCE

To help keep your UltraGroove Series tonneau cover looking its best, we recommend washing it the same as caring for your truck finish. However, you should not wax your cover. Using a citrus-based vinyl cleaner and UV Protectant will keep your cover looking like new.

To assure quiet, smooth operation, periodically apply a generous amount of UV Protectant to a rag and wipe out the inside of the rails, the underside of the sweep seals, and the top of the wear strips. Repeat as needed until these components are cleaned of debris and well lubricated.

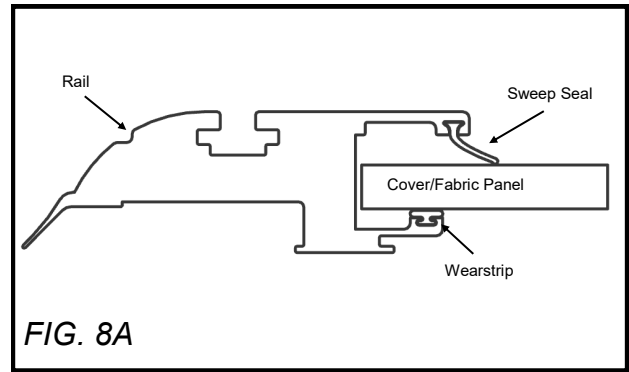

Ensure proper placement of the sweep seal as shown in step 9. Re-apply protectant/lubricant if the cover begins squeaking or sticking during use. (FIG. 8A)

Alcohol, petroleum or silicon-based cleaners such as should be avoided and ARE NOT recommended for our covers.

It is important to open and close the cover regularly; the spring that operates the cover is self-lubricated and regular use assures that it stays in proper working condition.

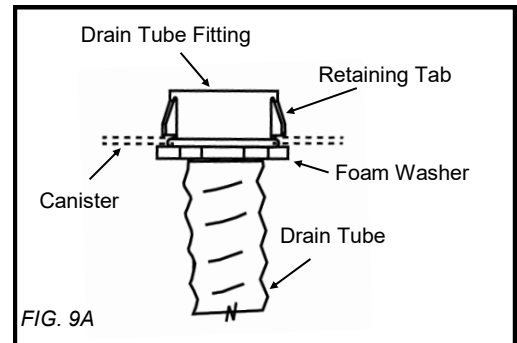

Periodically remove the Top Cover and clean out the inside of the canister.

Drain tubes may become clogged overtime and should be removed and cleaned. To remove the drain tubes reach under the canister, grab the drain tube fitting and turn it while applying light downward pressure. When the retaining tabs align with notches in the bottom of the canister the Drain Tube and Fitting will drop out. (FIG. 9A and FIG. 7A)

**ULTRAGROOVE™ METAL
FULL-METAL™ JACKRABBIT®
FULL-METAL JACKRABBIT MATTE
ULTIMATE LIFETIME WARRANTY**

This limited lifetime warranty covers: Failure of materials and workmanship. Warranty replacement will be issued at no cost for the life of the cover to the original owner on original vehicle – nontransferable.

- Separation of the UltraGroove Metal/Full Metal JackRabbit/Full Metal JackRabbit Matte deck panels
- All lock assemblies
- All hardware and components

**ULTRAGROOVE ELECTRIC
BEDLOCKER®/BEDLOCKER MATTE**

For a period of seven (7) years from the date of purchase the Pace – Edwards electric retractable cover has the following limited warranty:

- Failure of materials and workmanship
- Separation of the UltraGroove Electric/BedLocker/BedLocker Matte deck panels
- Failure of the UltraGroove Electric/BedLocker/BedLocker Matte drive system and electrical components
- All hardware and components
- Warranty will be prorated after five (5) years

**ULTRAGROOVE
JACKRABBIT/JACKRABBIT MATTE**

For a period of five (5) years from the date of purchase, the cover will have the following limited warranty:

- Delamination of the ArmorTek deck
- Failure of the Continuous Tension Spring
- All lock assemblies
- All hardware and components

SWITCHBLADE™/SWITCHBLADE METAL

For a period of two (2) years, the cover will have the following limited warranty:

- Delamination of the ArmorTek deck material
- Failure of the Continuous Tension Spring
- All hardware and components

EXCLUSIONS (ALL MODELS):

- Normal wear and tear over the life of the Pace Edwards cover (including fading or discoloration)
- Water intrusion at any location or any damage caused as a result
- Additional installed parts and accessories
- Acts of nature such as tornadoes or hurricanes, or other external causes

ITEMS WHICH WILL VOID WARRANTY:

- Use of lubrication other than prescribed in owners/ installation manual
- Misuse, negligence, or accident
- Improper installation of product
- Failure to adequately secure cargo to prevent damage to the Pace Edwards cover
- Installation of parts or accessory which may interfere with the Pace Edwards cover without written permission of Pace Edwards
- Additional installed parts and accessories
- Acts of nature such as tornadoes or hurricanes, or other external causes

CONDITIONS AND LIMITATIONS:

- Any part of the Pace Edwards retractable cover found to be defective under the terms of the warranty will be repaired or replaced, at the discretion of Pace Edwards.
- Pace Edwards will have the final decision if the part in question is defective.
- Pace Edwards has no responsibility with regards to installation by its dealers or agents.
- Pace Edwards does not, under any circumstances, assume response ability for loss of item, revenue, inconvenience, or other consequential damage including, but not limited to, expenses for telephone, food, lodging, travel, loss, or damage to the vehicle the cover is installed upon, or loss or damage to personal property of the purchaser or user of the product.
- Pace Edwards will not accept any responsibility to any purchaser for warranty expressed or implied by any of its dealers, distributors, or agents.
- Pace Edwards reserves the right to make changes in the design of, improvements to, or warranty of its products without imposing any obligation for any products manufactured.
- Under no circumstances will Pace Edwards be liable for special, indirect, incidental, or consequential damages incurred in connection with any Pace Edwards retractable cover or its accessories.

Effective February 20, 2023

Name _____
Address _____
City _____ State _____ Zip _____
Vehicle Year _____ Make _____ Model _____
Model Number _____ Serial Number _____
Email _____ Phone _____
Date of Purchase _____ Purchased From _____ Price Paid _____
Customer Signature _____

UltraGroove™ and UltraGroove™ Metal

Retractable Tonneau Covers



(800) 338-3697

www.paceedwards.com

Pace Edwards Company

2400 Commercial Blvd.

Centralia WA 98531